

Manual

Blade

CC-BL-1



About

The Blade 4" wall panel is a sleek control solution for modern smart homes. It can replace traditional KNX push buttons while offering a clean, elegant design. Its intuitive touchscreen gives you a clear overview of your home, making it easy to control lighting, shading, climate, and scenes from one central interface.



Installing Blade

1. Installing the Touch Panel

The Blade touch panel can be installed using either the provided flush-mounted wall box or a standard round box. Follow the alignment and height specifications below to ensure optimal functionality and aesthetics.

1.1 Mounting the Flush-Mounted Box

Install the flush-mounted wall box (supplied) into the wall. It is critical to ensure the box is perfectly level, both horizontally and vertically, to prevent the panel from appearing tilted.

- **Installation Height:** Note that the touch panel requires a different mounting height than standard light switches.

- **Recommendation:** For the best user experience and viewing angle, we recommend an installation height of approximately 145 cm from the floor to the bottom of the panel.

1.2 Alternative Mounting (Standard Round Box)

If the supplied box is not used, you may install the unit using a standard Ø60 mm round wall box.

Note: When using a Ø60 mm box, the Blade bezel will sit approximately 4 mm proud of the wall surface, creating a slight gap between the bezel and the wall.

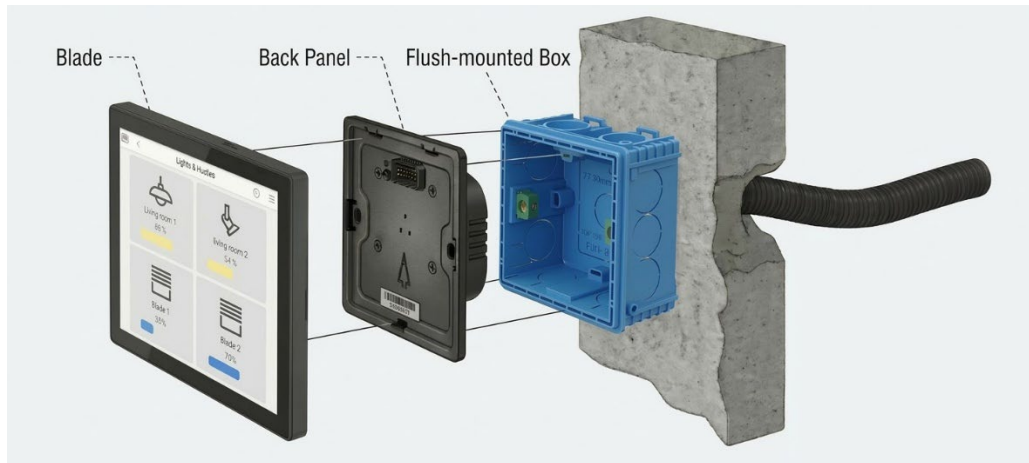

2. Blade power options

Blade wall panel offers flexible power and connectivity options. Depending on your infrastructure, follow the appropriate method below to initialize the device.

2.1 Power and Data options

The panel can be powered using one of two methods:

- **Power over Ethernet (PoE):** Connect a single Ethernet cable from a PoE-enabled switch to the panel. This provides both power and a wired network connection simultaneously.
- **DC Power Supply (9-24V):** Connect a dedicated DC power source. If using this method, the panel must be connected to your local network via a standard Ethernet cable or Wi-Fi.

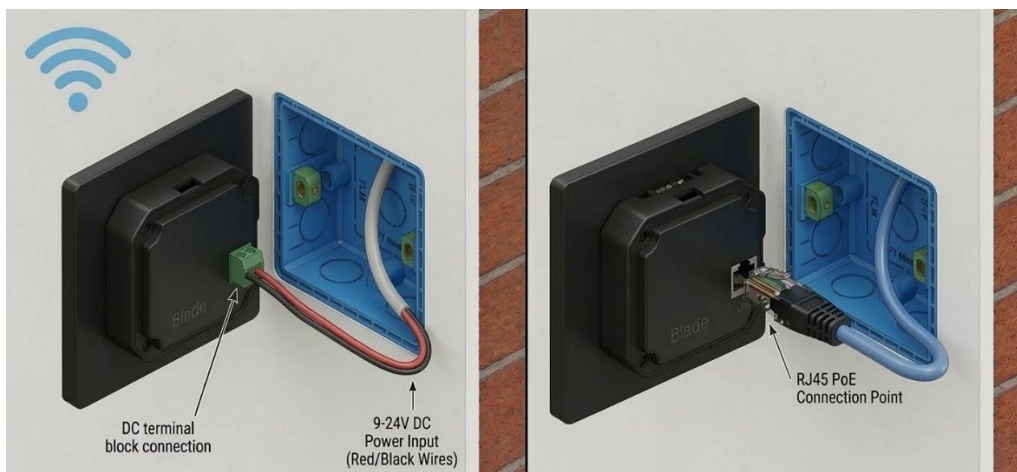

2.2 System Startup

Once the panel is wired and securely mounted into the wall box, locate the **Power Button** on the top-right corner. Press and hold the button until the screen illuminates and wait for the operating system to initialize.

2.3 Server connection

Once the panel is fully booted launch the bOS Client application from the home screen. Enter your Access ID, username and password to connect to your ComfortClick server.

2.4 Proximity Wake

The Blade features an integrated proximity sensor that manages the display. By default, the panel remains dimmed to save power; it illuminates automatically when motion is detected. You can adjust the detection range to prevent the panel from activating unnecessarily when you pass through the area.

By default, the Proximity Wake is already enabled. To adjust the detection distance,

navigate to the **Settings** menu in the top-right corner of the **bOS Client app**  and scroll down to **Proximity Threshold**. By opening this menu, you can configure exactly how close or far a person must be to trigger the sensor. The options are : Far (default), Medium, Close, Very close.

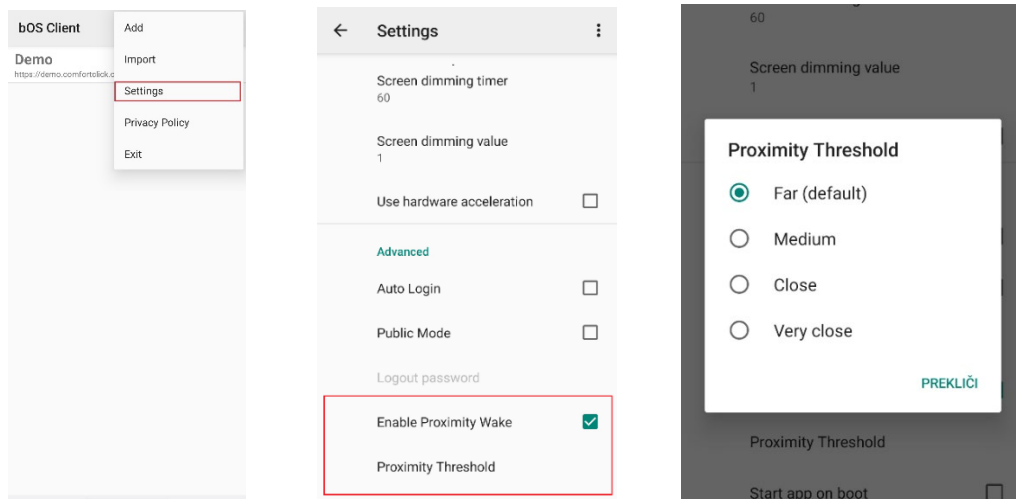

2.5 Public Mode

When Public Mode is enabled, the client behaves like a kiosk, restricting user access to the underlying operating system and system settings.

Key Features of Public Mode

- **Automatic Login:** The client bypasses the server selection and login screens, jumping straight to the visualization.
- **Full-Screen Lock:** The application runs in a dedicated full-screen mode, hiding the Windows taskbar, start menu, and close buttons.

- **Restricted Navigation:** Users are limited to the pages and controls defined in your configuration; they cannot access the bOS Client's local settings or change the connection profile.

Enabling Public Mode

To activate Public Mode, navigate to the **Settings** menu in the top-right corner of the bOS Client. Enable the **Public Mode** toggle and define a **Settings Password**. Once configured, the panel remains locked within the visualization; the password is required to exit the application or modify system settings.

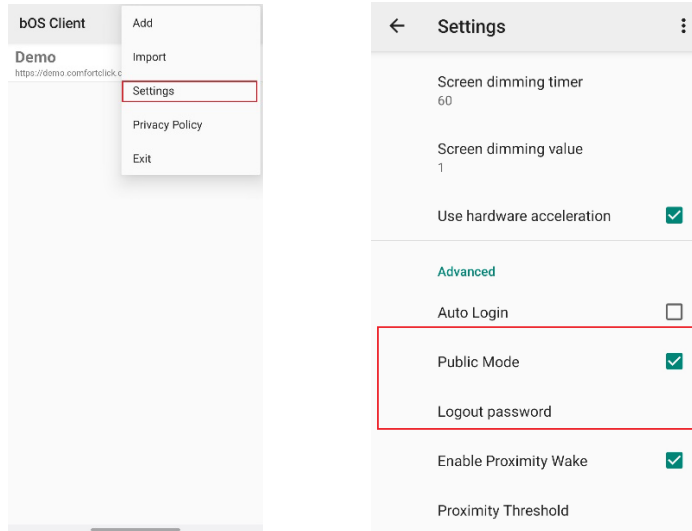

3. ComfortClick Intercom Configuration

The **Blade** wall panel comes with the **CC Intercom**  application pre-installed. This app utilizes the SIP protocol to ensure seamless communication with your home intercom system.

For more info on how to do ComfortClick intercom configuration follow the link:
<https://www.comfortclick.com/Support/KnowledgeBase/456785921>